



# FORD & PARTNERS

ESTATE AGENTS



## 35 Dewwood Court Pettifer Way, High Wycombe, HP12 3UH

\* INCENTIVES AVAILABLE - 50% OFF FIRST MONTHS RENT & FREE APPLIANCE PACKAGE - KETTLE, TOASTER & MICROWAVE \*

A stunning collection of just six two double bedroom apartments situated in Dewwood Court, a private development situated in close proximity to J4 M40.

The accommodation comprises of two double bedrooms, a modern family bathroom, fully fitted kitchen including appliances and a large reception room.

\* Subject to receiving holding deposit by 31st December 2025

**£1,350 Per month**

- NEWLY RENOVATED
- TWO DOUBLE BEDROOMS
- FULLY FITTED KITCHEN WITH APPLIANCES
- MODERN FAMILY BATHROOM
- FREE APPLIANCE PACKAGE - KETTLE, TOASTER & MICROWAVE\*
- AMPLE PARKING
- FAR REACHING VIEWS
- GROUND, FIRST & SECOND FLOOR APARTMENTS
- RESERVE YOUR NEW HOME TODAY!

## Pettifer Way, HP12 3UH

Approximate Gross Internal Area = 660 sq ft / 61.3 sq m  
Store = 17 sq ft / 1.6 sq m  
Total = 677 sq ft / 62.9 sq m



CH  
2.24 = Ceiling Height

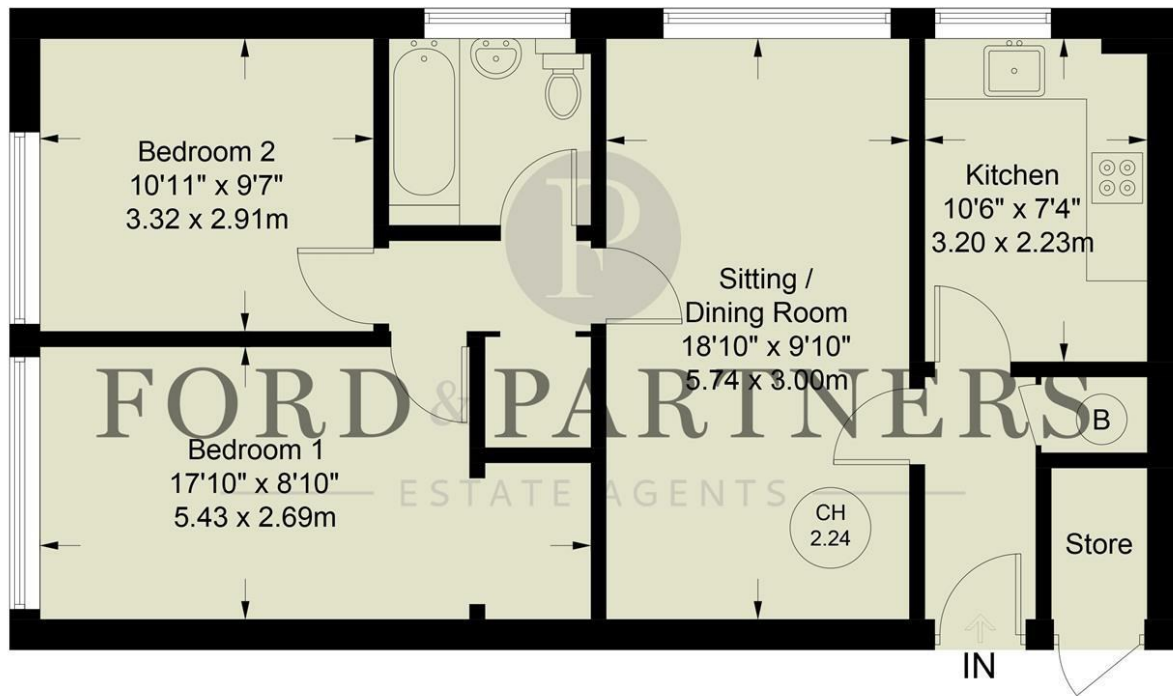

Floor Plan produced for Ford & Partners by Media Arcade ©.  
Illustration for identification purposes only. Window and door openings are approximate. Whilst every attempt is made to assure accuracy in the preparation of this plan, please check all dimensions, shapes and compass bearings before making any decisions reliant upon them.

Energy Efficiency Rating		
	Current	Potential
Very energy efficient - lower running costs		
(92 plus) <b>A</b>		
(81-91) <b>B</b>		
(69-80) <b>C</b>		
(55-68) <b>D</b>		
(39-54) <b>E</b>		
(21-38) <b>F</b>		
(1-20) <b>G</b>		
Not energy efficient - higher running costs		
<b>England &amp; Wales</b>	EU Directive 2002/91/EC	

Environmental Impact (CO <sub>2</sub> ) Rating		
	Current	Potential
Very environmentally friendly - lower CO <sub>2</sub> emissions		
(92 plus) <b>A</b>		
(81-91) <b>B</b>		
(69-80) <b>C</b>		
(55-68) <b>D</b>		
(39-54) <b>E</b>		
(21-38) <b>F</b>		
(1-20) <b>G</b>		
Not environmentally friendly - higher CO <sub>2</sub> emissions		
<b>England &amp; Wales</b>	EU Directive 2002/91/EC	

